

STAGNUM is a watertight surface-mounted armature with three sizes and configurations, differing in their light output. The equipment is made of materials that provide excellent resistance to the elements; a very competitive lighting solution with high added value.

With LEDs with a high color rendering index ($Ra > 80$) and high overall luminous efficacy of between 130 and 155 lm/W. LEDs with a long service life ($> 50,000$ h), with different color temperatures available.



PRODUCT DESCRIPTION

Assembly	Saliente;
Carcass	PC - Polycarbonato;
Watertight seal	PL - Poliutero;
Clamping springs	PC - Polycarbonato;
Application	Industrial spaces; Service areas; Garages; Car wash areas;
CRI	$Ra > 80$;
Diffuser	O - Opaline; (in polycarbonate)
Operating temperature	$Ta = 35^{\circ}C$;

ELECTRICAL SPECIFICATIONS

Max. Supply Current	275 mA;
Power Factor	$> 0,90$;
Class of electrical protection	I;

STANDARDS (PRODUCTS MANUFACTURED ACCORDING TO:)

EN 60598-1:2004

PACKAGE

Model	Dimension (mm)	Weight (Kg)
600	700x110x100	1,3
1200	1300x110x100	2,1
1500	1600x110x100	2,5

FINISHES

Gr	Grey (Polycarbonate)
----	----------------------

Other finishes on request

PRODUCT OPTIONS

Emergency kit;
HFS sensor;
20% opal diffuser - 1200 | 1500;
Semi-opal diffuser - 600;

MECHANICAL DRAWINGS (mm)

MODEL	L1 (mm)	Distance between holes D1 (mm)
600	660	390
1200	1277	800
1500	1573	1100

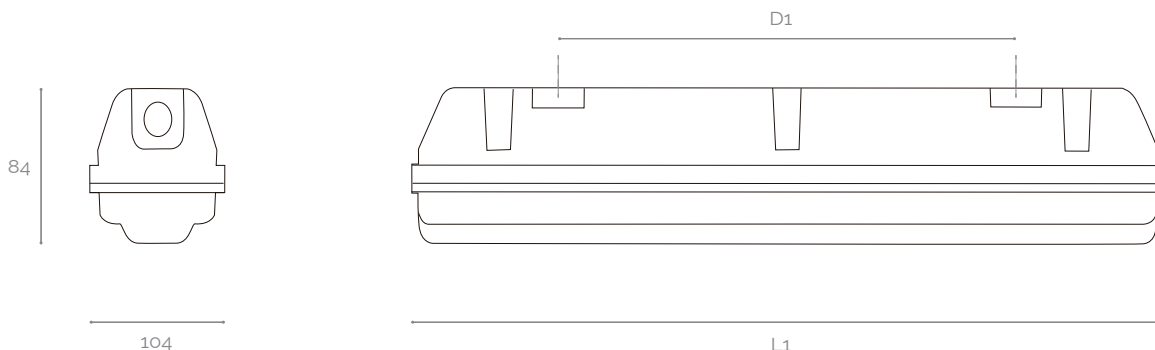

PHOTOMETRIC SPECIFICATIONS

MODEL	PERFORMANCE	POWER (W)	PHOTOMETRIC CODE	LUMINOUS FLUX (lm)	SYSTEM EFFICIENCY* (lm/W)
600 (Aprox. 660 mm)	HO	21	827	5406	130
			830	5648	136
			840	5971	144
			850	5971	144
	HE	15	827	4008	134
			830	4188	140
			840	4427	148
			850	4427	148
1200 (Aprox. 1277 mm)	HO	42	827	10812	135
			830	11296	141
			840	11942	149
			850	11942	149
	HE	30	827	8017	139
			830	8376	145
			840	8854	153
			850	8854	153
1500 (Aprox. 1573 mm)	HO	51	827	13515	136
			830	14120	142
			840	14927	150
			850	14927	150
	HE	37	827	10021	140
			830	10470	146
			840	11068	155
			850	11068	155

NOTE: Nominal values for frosted diffuser | (*) - Normal system (without control);
The luminous flux and input power of the luminaire are indicative values valid for an ambient temperature of 25°C. The actual flux emitted by the luminaire depends on environmental conditions (e.g. temperature and pollution) and may vary according to specific configurations. The reported values are subject to the tolerances in technology.

HO - High output flux;
HE - High efficiency;

DIFFUSER OPTIONS

ILLUSTRATIVE IMAGES



20% OPAL DIFFUSER
STAGNUM LED II (1200/1500)



SEMI-OPAL DIFFUSER
STAGNUM LED II (600)

POLAR DIAGRAM

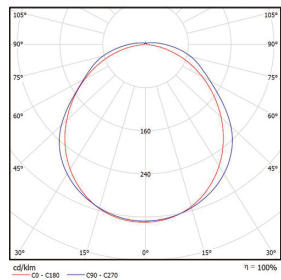

O

ORDER EXAMPLE

PRODUCT FAMILY	PERFORMANCE	PHOTOMETRIC CODE	DIFFUSER	FINISHING	OPTIONS
STAGNUM LED II (600)	HE	830	O	Cz	Semi-opal diffuser

ILLUSTRATIVE IMAGES

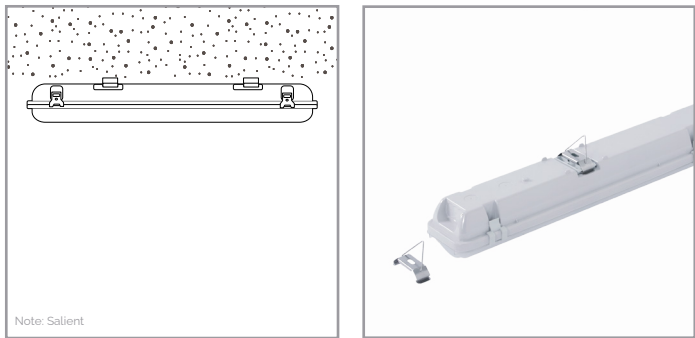

NOTES

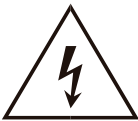

RISK OF
ELECTRIC SHOCK

This device is suitable for pricking out.
Light source not user-replaceable.

For more information on the different architectures, solutions and functionalities available, please contact Lightenjin.
Under the general terms of the supply of our services and/or equipment, Lightenjin declines any responsibility for the use or purpose assigned to them, which are the sole and exclusive responsibility of the customer.
Lightenjin reserves the right to change the information contained in this document without prior notice.

LIGHTENJIN II - LIGHTING INDUSTRY, LDA

PARQUE EMPRESARIAL DO CASARÃO, AVENIDA DAS 2 RODAS, LOTE 36A. 3750-041 ÁGUADA DE CIMA | PORTUGAL
tel: +351 234 080 117 | fax: +351 234 640 064 | geral@lightenjin.pt

